

EVERETT

STREET 26'-0" WIDE  
(CONCRETE PAVING)

ST.

NOTE: NO WALKS IN ON THIS SIDE OF STREET

# PLOT PLAN SCALE 1" = 20' SUMNER HIGH AND DOUGLASS SCHOOLS

34

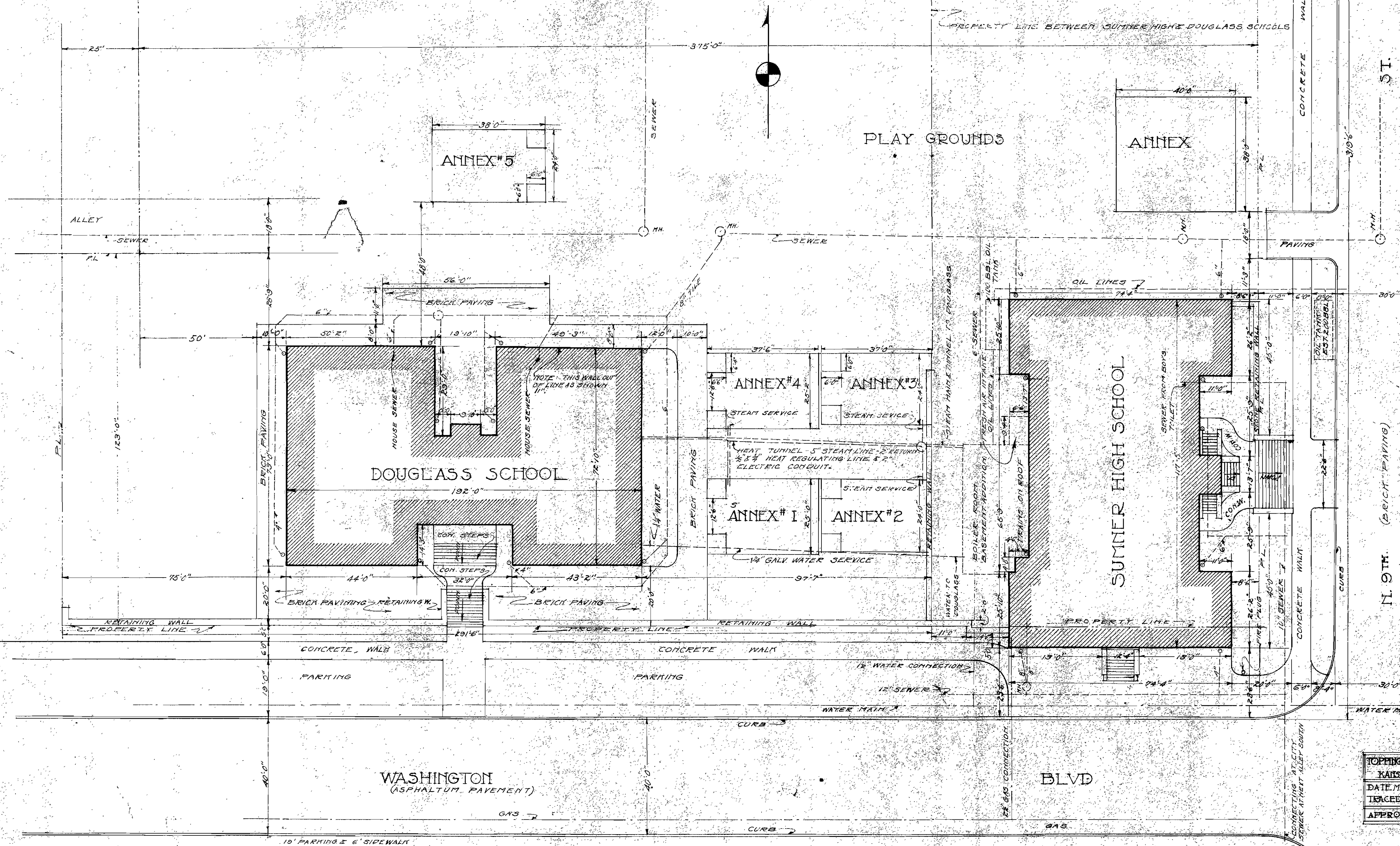

TOPPING VALUATION COMPANY  
KANSAS CITY MISSOURI  
DATE MAY 1921 DRAWN A.R.S.  
TRACED F.E.D. CHECKED A.R.S.  
APPROVED F.V.C.